

# TIGERGRIP / TG 100SM

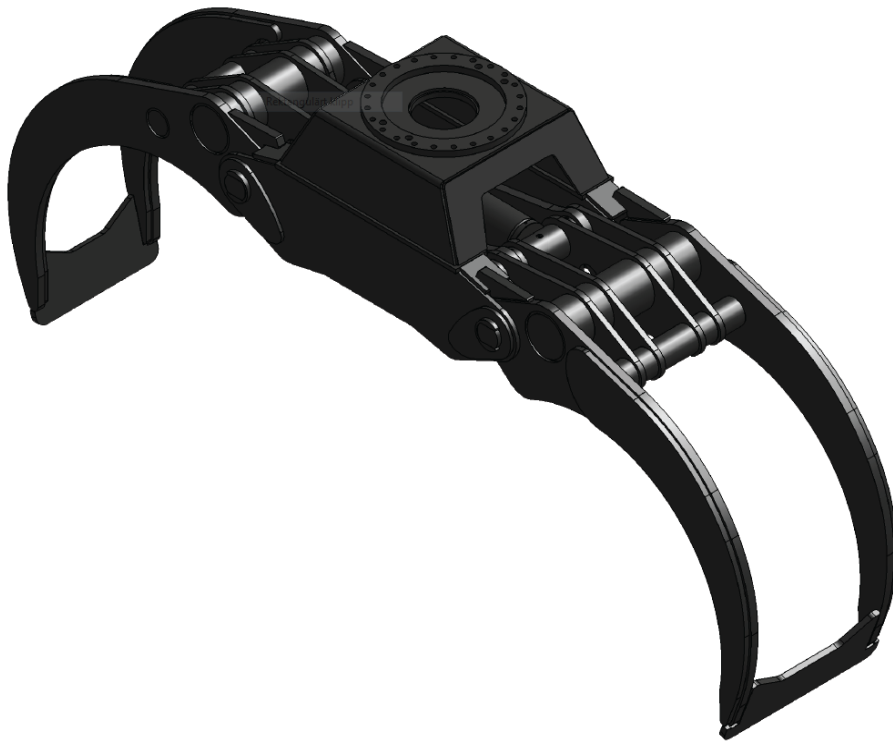

## KEY FEATURES

- Heavy duty
- Double guide bars
- Optimized roll in/roll out properties
- High pressure cylinder with double piston rod seals
- High tensile wear resistant steel (400 HB)
- Extra reinforced body for rigid mounting - excavator design

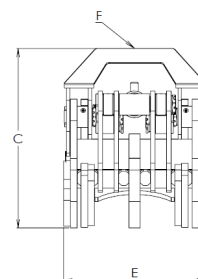
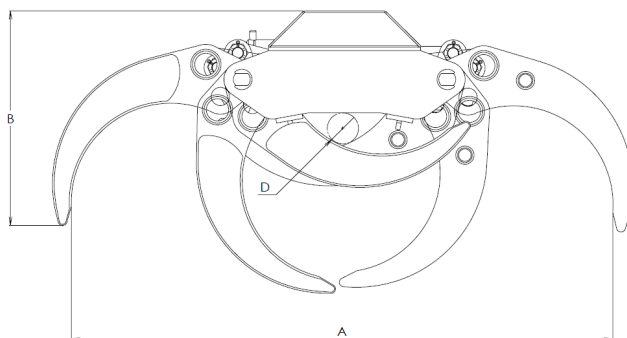

<b>A</b>	2948
<b>B</b>	1432
<b>C</b>	985
<b>D</b>	170
<b>E</b>	702
<b>F</b>	-

## MODEL SPECIFICATIONS



TG 100SM

1357

1

300

90

38

12

40

45

# INTERMERCATO

High performance lift and load attachments for Forestry, Transport, Construction and Recycling.

